



Floor Map and Vendor Section “Menu”

Match the number on the space on the floor map to the number on the menu description for details about the section. Some areas are more appropriate than others for certain merchandise. Please be aware that your interest in a particular section must also be in agreeance with the Emporium curator before lease agreement can be made.

Floor Map

This map is not exactly to scale. For an accurate representation, please come see us in person.

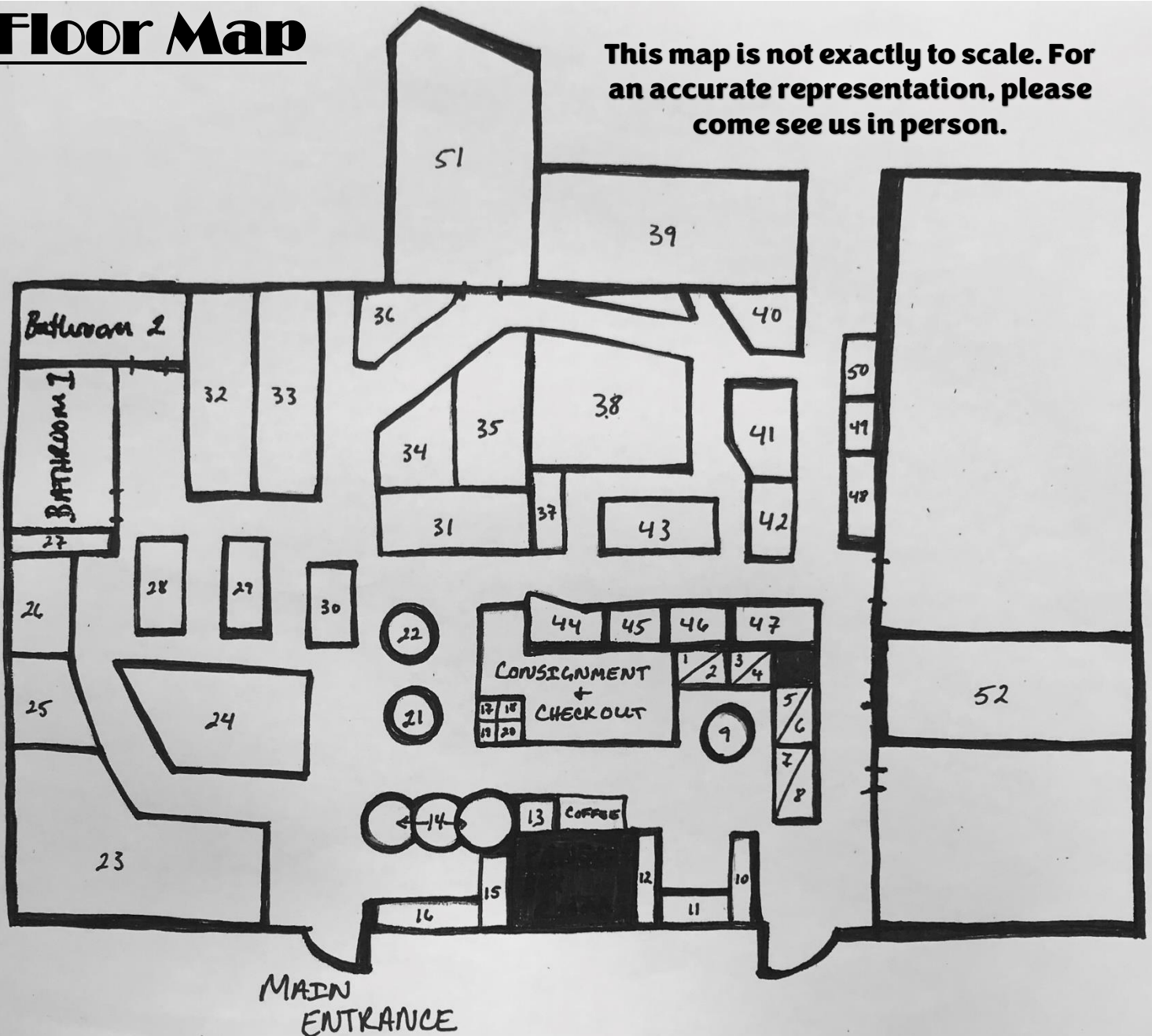

Vendor Section “Menu”

Sections 1 through 8- large metal shelving units. Upper and lower sections with adjustable shelving available. Use magnets and different materials to give your section your own look. If you are renting an upper section, you can use the top of the unit as well. Each section is approximately 4’ wide, 2’ deep, and 3’ tall. **Rent either an upper or lower section at \$25 per month.**

Section 9- 4’ round wood table with metal base and somewhat adjustable height. Located in a prominent space near the consignment/check out area. 360° visibility and great space for a showstopper centerpiece. The floor space around the table is usable for this section as well. **Rent this table at \$35 per month.**

Sections 10, 11, and 12- large metal and wood shelving units- these unique iron and repurposed adjustable wooden shelves in a nook located in the front of the store. Little nook has its own lighting and each unit is its own section. Each section can have up to 4 shelves. Lots of outlets in this section for lamps/lighting. **Rent each section at \$50 per month.**

Section 13- little blue vintage hutch with glass doors. Use this piece supplied by the Emporium to display your little wares and create a unique display using pulled drawers. This section has high visibility and is located directly beside the free customer coffee table at the front of the store. This section is closely monitored by staff since it is right across the check-out counter. Lots of outlets in this section for lamps/lighting. **Use this piece or bring your own at \$30 per month.**

Section 14- 3 nested 4’ round wood tables with metal bases. Located directly in the entrance of the Emporium. This section is reserved vendors who are selling live plants, seasonal, agricultural merchandise. There is east facing window across from this section and includes the floor space below the tabletops. This section has three-sided accessibility. **Rent this section at \$75 per month.**

Section 15- large metal and wood shelving unit- this unique iron and repurposed wooden shelved unit beside an east facing window directly in the entrance of store and can have up to 4 shelves. This section is reserved vendors who are selling live plants, seasonal, agricultural merchandise. Lots of outlets in this section for grow lamps/lighting. **Rent this section at \$50 per month.**

Section 16- small wooden table directly in front of the east facing window in the entrance of the store. This section is reserved for vendors who are selling live plants, seasonal, agricultural merchandise. With the window in this section, it is perfect for stained glass, plants, and anything you want customers to see from the outside of the store. Perfect opportunity to advertise whatever else you may have happening outside of the Emporium as well. **Use this table or bring your own at \$40 per month.**

Sections 17-20- A vintage revolving display case split into 4 vendor section sides. Each section consists of one complete side of the encased lighted display with a total of 15 spaces for small individually displayed merchandise. Case is maintained and assisted by Emporium staff; guests will not be able to access the case themselves. This is a great space to have small, valuable things under tight staff supervision, without the consignment fee. **Rent each section at \$10 per month.**

Sections 21 and 22- 4’ round wood table with metal base and somewhat adjustable height. Located directly in the front entrance of the store and will be the first things seen. Tables are directly in front of the consignment/check out area. 360° visibility and great space for a showstopper centerpiece. The floor space around each table is usable for these sections as well. **Rent each table at \$40 per month.**

Section 23- approximately 65 square feet floor space at the very front of the store to the left of the front door. Includes generous walkway access and an east facing window. Has lots of drywall space for hanging art or merchandise. This section would be appropriate for vendors selling small furniture and/or large inventory of goods. Lots of outlets in this section for lamps/lighting. **Rent this section at \$225 per month**

Section 24- approximately 50 square feet of 360° floor space right in the middle of the front entrance area of the store. This prime location offers complete walk around access to the section, leaving endless creative ways to build this section. Having the best visibility of any of the sections of the store, this one is very desirable. Would be suitable for vendors selling small furniture pieces. **Rent this space at \$175 per month.**

Section 25- approximately 15 square feet of floor space and ample dry wall space carved out of the prime section of the floor plan. Includes great access to the walkway and makes an opportunity to use the wall and floor as one huge space. Great lighting and complimentary vendor neighbors. This space is excellent for someone selling art to be hung on a wall. Lots of outlets in this section for lamps/lighting. **Rent this section at \$55 per month.**

Section 26- approximately 12 feet of floor space and lots of dry wall space located in the front left corner of the store, close to the bathrooms. Great visibility and perfect for a vendor selling lots of art to be hung on the wall. Lots of outlets in this section for lamps/lighting. **Rent this section at \$50 per month**

Section 27- approximately 8 square feet of floor space nestled in the front left corner of the main section of the store. Drywall area for hanging and direct eyeball spotlights directly above. This section is unique because of the option of a drain and hot/cold water hookup! So many things you could do- a little product station where you can wash your hands, display a beautiful, working antique sink, set up a food tasting station, etc. Lots of outlets in this section for lamps/lighting. **Rent this section at \$45 per month**

Sections 28, 29, and 30- these sections are mobile, 5' long, 2' deep, and 4' tall rolling steel metal carts with optional wooden shelving. Each cart can hold 4 shelves, including one on the top. These carts are suitable for all kinds of merchandise and can be custom configured for all kinds of shapes and sizes. Super durable so they can handle a ton of weight. These sections will be moved daily around the open spaces at the Emporium to give a fresh look and feel to the store every day. Merchandise not suitable for carts is anything that would be unstable and breakable when moving. **Rent one of these sections at \$35 per month**

Section 31- approximately 35 square feet of high visitor visibility. This section is straight ahead when you walk into the store and is directly in front of the main pathway. Use the curved glass hutch and floor space for your set up or bring your own pieces. Lots of outlets in this section for lamps/lighting. There is painted concrete block wall space in this section for hanging merchandise or display piece. **Use this piece or bring your own at \$175 per month**

Section 32- approximately 50 square feet, this section is in the back of the store on metal diamond plate flooring. This gives a different feel to the whole space and includes dry wall space with eyeball spot lighting and a small section of painted concrete wall space. Lots of outlets in this section for lamps/lighting. This section would be great for a vendor selling small furniture. Use the custom hutch display piece there or bring your own. **Rent this section at \$175 per month**

Section 33- approximately 30 square feet, this section is in the back of the store on metal diamond plate flooring. This gives a different feel to the whole space a small section of painted concrete wall space. This section would be great for a vendor selling small furniture. Lots of outlets in this section for lamps/lighting. Get creative with your set up using the generous access to the main walkway through the store. **Rent this section at \$175 per month**

Section 34- approximately 17 square feet, this little section is one of three in a prime section in the store. It is located directly in front of the main walkway and has lots of exposure as people walk by. There is no wall space in this section, leaving you to create an almost 360° view of your merchandise. **Rent this section at \$60 per month**

Section 35- approximately 40 square feet, this section is loaded with painted concrete block wall. This is great wall space for art or other things that need height and wall space to be seen. The way this section is nestled along the main walkway, it creates the perfect nook for themed vendor. Lots of outlets in this section for lamps/lighting.

Rent this section at \$175 per month

Section 36- this is a mini section, located against the back wall, right in the fork of the walkway. Its perfect for a small vendor who needs great visibility, but a small space for merchandise. Use the wall space for art or display unit. Use the one that's there or bring your own. **Rent this section at \$30 per month**

Section 37- approximately 8 square feet against a section of painted concrete block wall, to the immediate left in the second section of the store. Use the antique wooden vanity there for display or use your own. Lots of outlets in this section for lamps/lighting. **Rent this section at \$30 per month**

Section 38- approximately 60 square feet in the second section of the store. Has lots of painted concrete wall space, plus eyeball spotlighting. Generous exposure to the main walkway. Lots of outlets in this section for lamps/lighting. Use the bedframe/table display or bring your own. **Rent this section at \$200 per month**

Section 39- approximately 47 square feet in its own little room with big picture window. Great for themed vendors. Has two cute clear prism chandeliers for lighting. There is a hanging clothes shelf and bar existing and has drywall space as well as painted concrete block wall space for hanging merchandise or displays. This section also includes a little sliver of space outside of the door into in the walkway. This is perfect for signage, a small rack, etc.

Rent this section at \$150 per month

Section 40- located in the back corner of the Emporium, this section is approximately 15 square feet and has drywall for merchandise or display area. With generous access to the main walkway through this area of the store, it creates almost a 360° view of merchandise/display. **Rent this section at \$45 per month**

Section 41- approximately 23 square feet of prime space in the second section of the store. Perfect for a vendor who wants to sell small furniture or other floor standing items. With generous access to the main walkway in this area, it creates almost a 360° view of the display and merchandise. There are endless ways to be creative and continually re-create this section. **Rent this section at \$65 per month**

Section 42- approximately 11 square feet of prime space in the second section of the store. Perfect for a vendor who wants to sell small furniture or other floor standing items. With generous access to the main walkway in this area, it creates almost a 360° view of the display and merchandise. There are endless ways to be creative and continually re-create this section. Use the wooden display furniture that is there or bring your own.

Rent this section at \$35 per month

Section 43- approximately 14 square feet of prime space in the second section of the store. Perfect for a vendor who wants to sell small furniture or other floor standing items. With generous access to the main walkway in this area, it creates almost a 360° view of the display and merchandise. There are endless ways to be creative and continually re-create this section. Use the wooden display furniture that is there or bring your own.

Rent this section at \$45 per month

Section 44- located immediately at the entrance of the second part of the store, this little square footage has great visibility and impact, approximately 11 square feet. Visitors will see this area coming and going. Use the wooden display furniture there or bring your own. Lots of outlets in this section for lamps/lighting Has painted concrete block wall space for merchandise or display. **Rent this section at \$35**

Section 45- along the main walkway in the second section, this little square footage has great visibility and impact- almost 6 square feet. Use the wooden display furniture that is there or bring your own. Has painted concrete block wall space for merchandise or display. Lots of outlets in this section for lamps/lighting **Rent this section at \$30 per month**

Section 46- along the main walkway in the second section, this little square footage has great visibility and impact- almost 6 square feet. Use the wooden display furniture that is there or bring your own. Has painted concrete block wall space for merchandise or display. Lots of outlets in this section for lamps/lighting **Rent this section at \$30 per month**

Section 47- along the main walkway in the second section and by another doorway, this little square footage has great visibility and impact- almost 10 square feet. Use the wooden display furniture that is there or bring your own. Has painted concrete block wall space for merchandise or display. Lots of outlets in this section for lamps/lighting **Rent this section at \$35 per month**

Section 48- along the main walkway in the second section, this little square footage has great visibility and impact- almost 9 square feet. Use the wooden display furniture that is there or bring your own. Has drywall space for hanging merchandise or displays. **Rent this section at \$30 per month**

Section 49- along the main walkway in the second section, this little square footage has great visibility and impact- almost 9 square feet. Use the wooden display furniture that is there or bring your own. Has drywall space for hanging merchandise or displays. **Rent this section at \$30 per month**

Section 50- TBD

Section 51- COMING SOON! Private studio/rental section. Approx. 200 sq ft. Use to make and/or sell whatever it is you do! **Rent this space for \$200 per month**

Section 52- COMING SOON! Private studio/rental section. Approx. 125 sq ft. Use to make and/or sell whatever it is you do! **Rent this space for \$100 per month**

General Info About Each Section

*Each section can use the wall space included within its boundaries up to the wooden trim line.

*Anything hung on the walls can be done with assistance from Emporium staff

*Floor space can be used under rented tables if whatever it is on the floor is easily moved to be cleaned and does not go over the 4' diameter of the tabletop. The bottom of the table is a great place to display things.

*The Emporium has filled the vendor spaces with generous, beautiful warm white light in a combination of chandeliers and track lighting that makes everything look good! If you would like to add lighting to your section, Emporium staff will help you install it. You can either purchase LED track light heads to add to the existing track light system in your section or you can plan for your own LED lighting. Regardless of choice, Emporium staff is required to help you install and oversee the connections. This is just to make sure that all the electricity is safe in all the sections.

*Feel free to advertise your other ventures outside of the Emporium in your section. Whether it's events, another location, website, etc, your space is the perfect spot for something like that to be seen. If you have a window in your section, you can advertise in a small section of the window anything you'd want to be seen. Advertising in windows can be up to a legal sized sheet of paper or the like.